

The Haven, Hambledon Road Denmead, PO7 6ER

Adjustment to condition 9 of permission 17/00907/FUL,
following consultation with HCC and assigned Civil Engineers ,
to avoid any conflicts with neighbouring land.

Proposal to reduce the 'x' distance for visibility splays at the
access to Hambledon Road to 2m

Application No: 20/01383/FUL

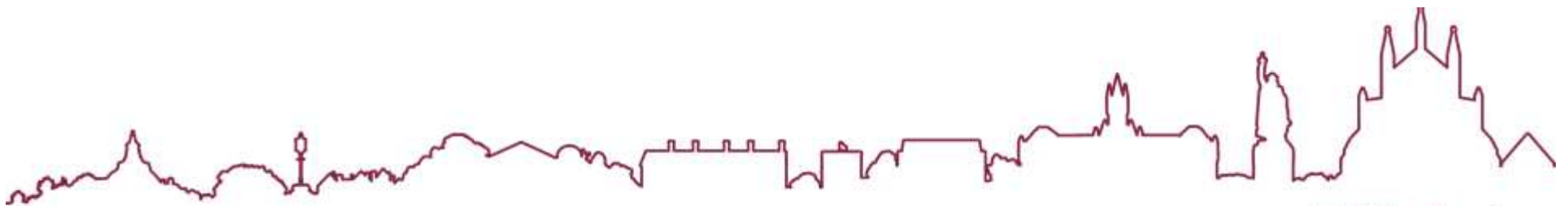





-  20mm overhead (withstands)
-  20mm overhead (withstands)
-  20mm overhead, not with 20mm overhead, flush at path junction
-  Boundary Edge
-  Transition Zone
-  200mm, 20mm overhead
-  Highway Boundary
-  Road Protection Zone (Refer to 6.10.1.1)

THIS DOCUMENT IS THE PROPERTY OF
CONCRETE CONSTRUCTION LIMITED
 ALL RIGHTS RESERVED. NO PART OF
 THIS DOCUMENT IS TO BE REPRODUCED
 OR TRANSMITTED IN ANY FORM OR BY
 ANY MEANS, ELECTRONIC OR MECHANICAL,
 INCLUDING PHOTOCOPYING, RECORDING,
 OR BY ANY INFORMATION STORAGE
 AND RETRIEVAL SYSTEM, WITHOUT
 PERMISSION IN WRITING FROM CONCRETE
 CONSTRUCTION LIMITED.

Original Design Copyright © 2011
 All Rights Reserved. Concreto Ltd
 111, Phoenix Road, London, UK
 Registered Office: 111, Phoenix Road,
 London, UK. Registered in England
 No. 08428282

Planning 101 Landmark
 Services are being provided to the
 site in order to ensure that the
 site is safe and secure. The
 services are being provided to the
 site in order to ensure that the
 site is safe and secure.



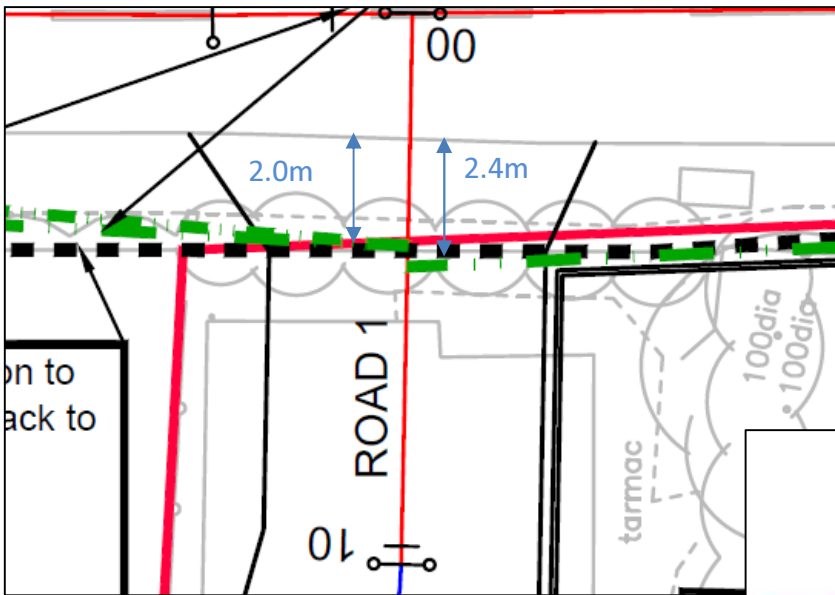
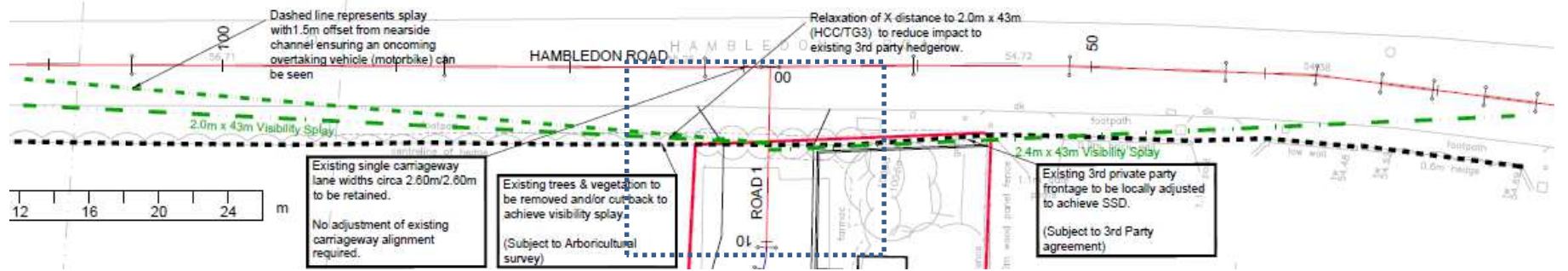

Currently proposed lines of sight

Magnified section

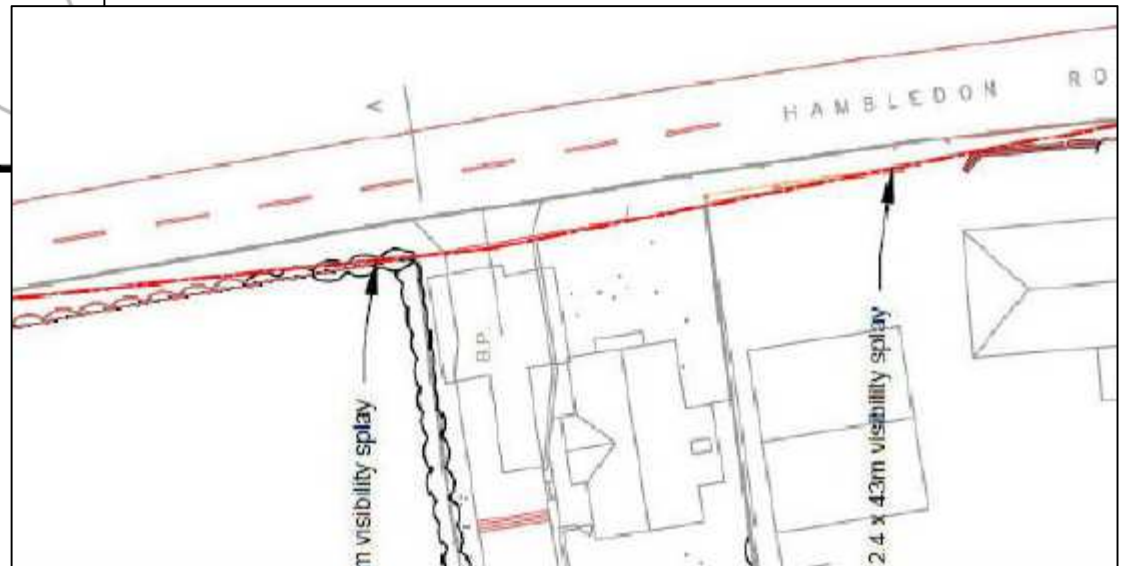

Visibility drawing –
Transport Statement
for original application



View from south, looking towards access



Wall on frontage of 'Oakwell' reduced in height to avoid conflict with line of sight.



View north from roadside



View south from roadside



View north with 'x' distance
of 2m



View north with 'x' distance
of 2.4m



View south with 'x'
distance of 2m



View south with 'x'
distance of 2.4m



Both views obstructed by
hoarding, now partially removed
since previous site visit in July



Line of existing hedge, wire mesh fence just visible in centre



Recommendation – Permit

The reduction in the 'X' distance at the access from Hambledon Road into the development has been comprehensively scrutinised and will not require a departure from standards or result in an increased risk to highway safety